

Processus de pose

Etape 1

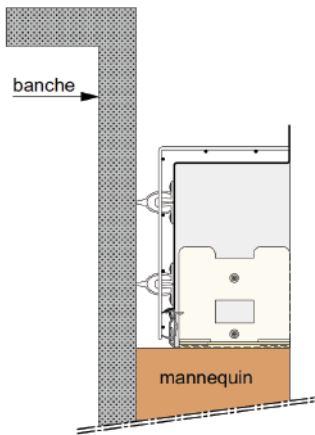

Etape 2

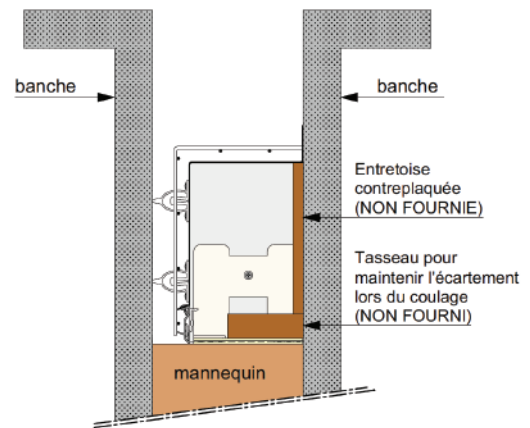

Etape 3

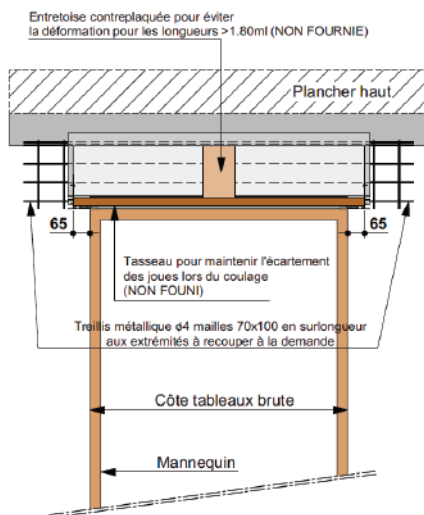

Etape 4

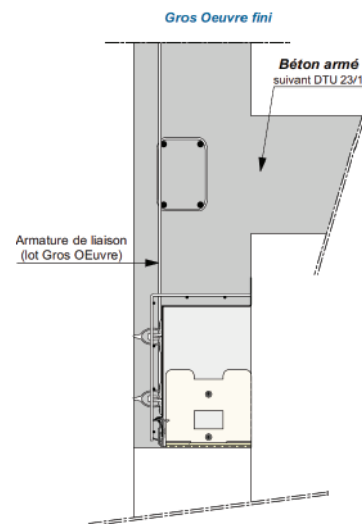

Processus de pose du Bloc Baie

Etape 5 Gros oeuvre fini

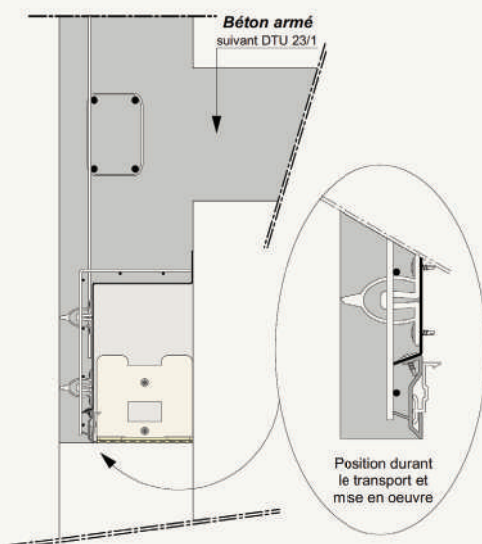

Etape 6

Retourner le profil en L avant de poser les menuiseries
Mettre quelques points de colle pour la fixer définitivement

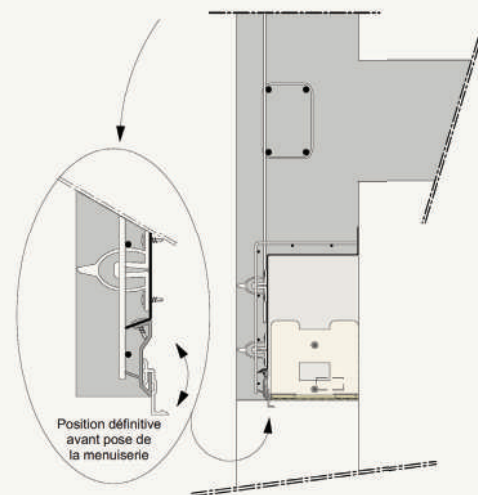

Etape 7 Approche bloc baie

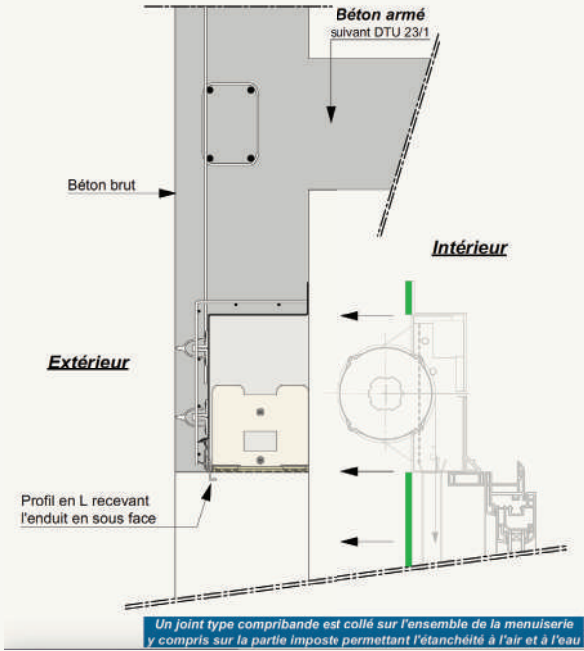

Etape 8 Gros oeuvre fini + bloc baie posé

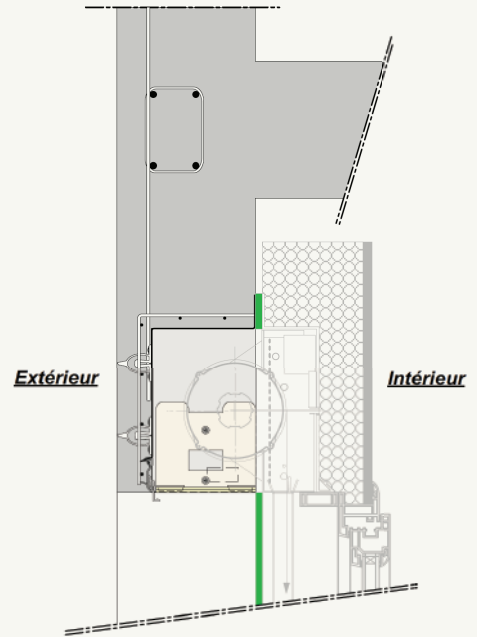

Coupe de principe avec enduit en façade et sous face du Kofrisol TLS avec Bloc Baie

